

# PUBLIC AUCTION of CHRISTIAN COUNTY FARMLAND

**Wednesday, October 1, 2014 • 7 pm**

**50 ACRES OF PRIME CHRISTIAN CO. FARMLAND**

AUCTION TO BE HELD AT

**Christian Co. Extension Office**

**1120 N. Webster St., Taylorville, IL**

THE PROPERTY IS AN UNIMPROVED 50 ACRES, MORE OR LESS, ALL TILLABLE, LOCATED APPX. 1 3/4 MILES EAST OF EDINBURG ILLINOIS.

LEGAL: THE NORTH 50 ACRES OF THE E 1/2 OF THE SOUTH-WEST 1/4 SECTION 17, TOWNSHIP 14 NORTH, RANGE 2 WEST OF THE THIRD PRINCIPAL MERIDIAN, BUCKHART TOWNSHIP (EAST PART) CHRISTIAN CO. ILLINOIS

Perm Parcel #03-08-17-300-002-00

**Taxes:** Appx. \$1,098.42 - 2013 paid in 2014

**FSA Info:** Corn Base = 30.0 Direct Yield 135 CC Yield 163

Bean Base = 16.20 Direct Yield 30 CC Yield 36

Wheat Base = 3.80 Direct Yield 56 CC Yield 44

Yield History: Corn 180 Beans 60



TERMS: \$10,000  
DOWN PAYMENT AT  
TIME OF AUCTION  
AND BALANCE AT  
CLOSING ON OR  
BEFORE NOV. 10,  
2014 BUYER WILL  
BE REQUIRED TO  
ENTER INTO A  
WRITTEN CON-  
TRACT AT THE TIME  
OF THE AUCTION.

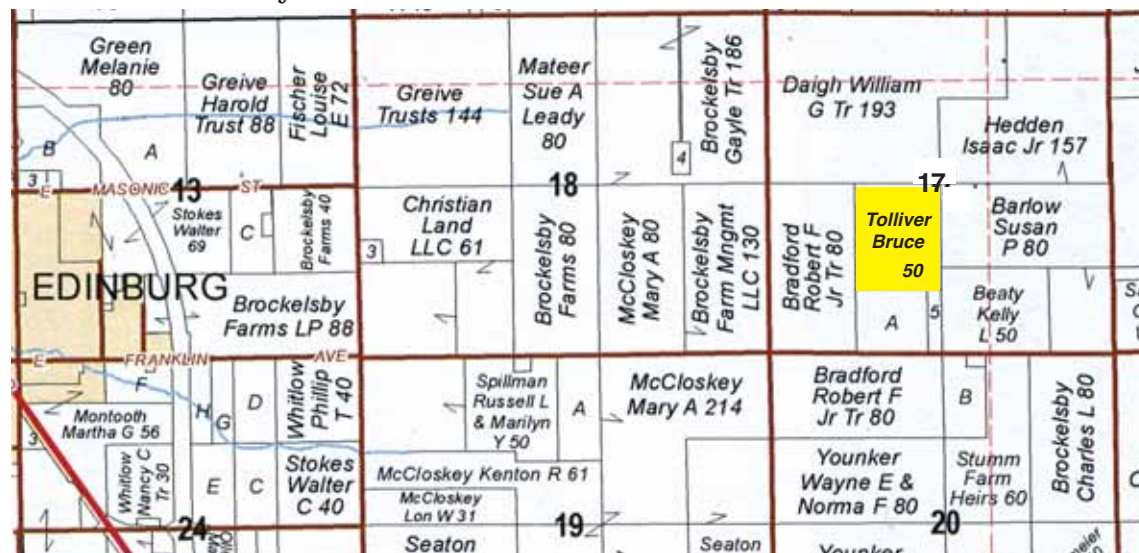

used with permission of Rockford Map Publishers

TITLE POLICY SHOWING MERCHANTABLE TITLE WILL BE FURNISHED SUBJECT TO EASEMENTS AND RESTRICTIONS OF RECORD IN PLACE  
POSSESSION: AT COMPLETION OF FALL HARVEST SUBJECT TO PRESENT TENANTS RIGHTS DANNY PUCETTI

**ANNOUNCEMENTS AT TIME OF AUCTION SHALL TAKE PRECEDENCE OVER ALL PRINTED MATERIAL.**

**Bruce D. Tolliver, Owner**

Daniel W. Austin Atty. 217-824-4931

**MICENHEIMER AUCTION SERVICE**

**James Micenheimer Auctioneer**

TAYLORVILLE, ILLINOIS

217-824-9324 for information

www.micenheimer.com

ILL. Lic# 440000896

